

## !!! BEFORE YOU BEGIN

Read these instructions completely and carefully



## WARNING

Risk of electrical shock. Disconnect power before servicing or installing product.

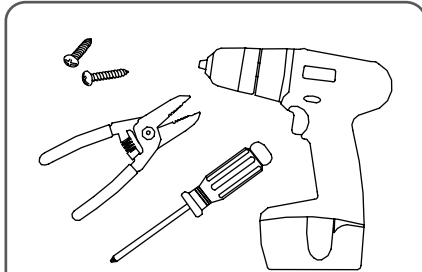

**Tools required:**  
Wire strippers, drill and screwdriver and screws.

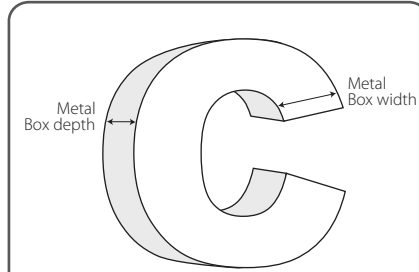

1 Noting metal box depth, width and face material, use layout guidelines and power supply capacity charts on page 2 to determine spacing and quantity of LEDs.

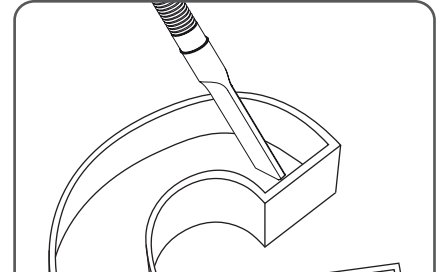

2 Clean and remove all debris inside the channel letters.

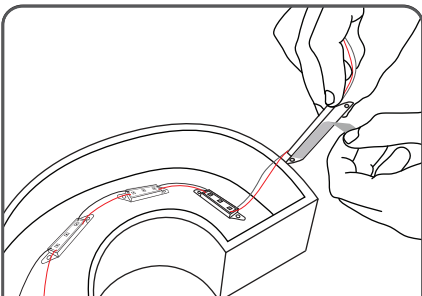

3 Using LED placement from step 1, remove tapes on the backside and stick LED modules into place.

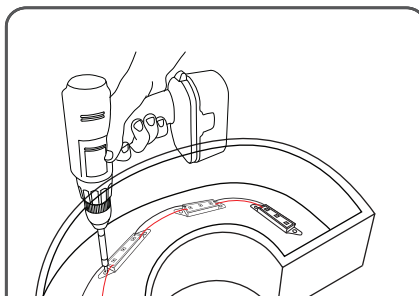

4 For firm fixing, use rivets or screws to secure the LED strip within the channel letter.

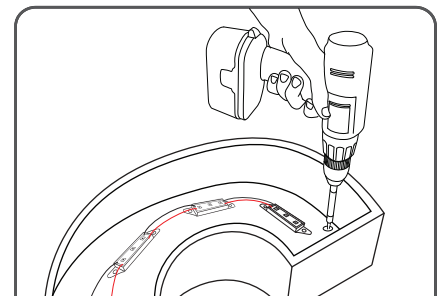

5 Drill the holes at the bottom or side of the letters for the wire connection to DC power supplies and grommet the hole for supply wire access.

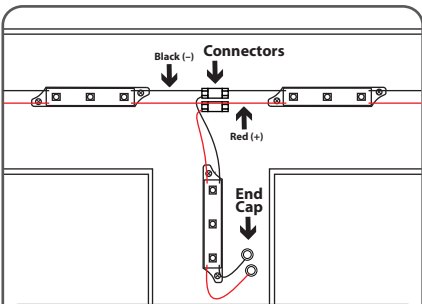

6 Modules may be connected in series or parallel with connectors. Cap all unused wires. The strand of modules should not be looped to create a closed circuit.

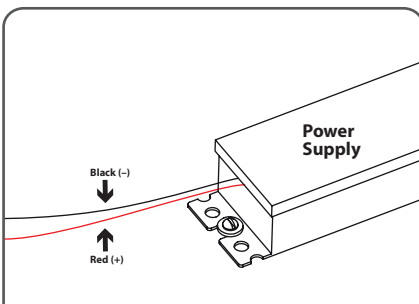

7 Run a wire from the Power Supply to each channel letter and connect to the first LED module on the strip. Must be used with 12 V BaltLED Power Supplies.

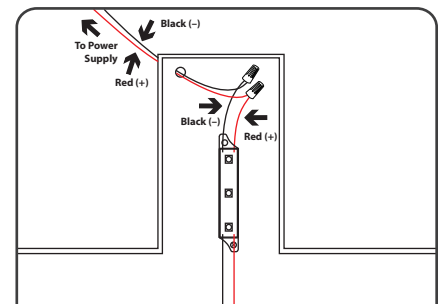

8 Connect the Red wire (+) of the LED strip to the Red wire (+) of the power supply. Connect the black wire (-) of the LED strip to the black wire (-) of the power supply.

## Malfunction&Solutions Table

Malfunction	Probable Causes	Solutions
Non LED work	<ol style="list-style-type: none"> <li>No power from power supply.</li> <li>Short circuit or automatic short circuit protection of power supply.</li> <li>Power supply fuse is burnt.</li> </ol>	<ol style="list-style-type: none"> <li>Supply power.</li> <li>Troubleshoot short circuit and supply power again.</li> <li>Replace the burnt fuse with a new one.</li> </ol>
Part of the LED module strings don't work	<ol style="list-style-type: none"> <li>No power from power supply (ies).</li> <li>Some LED module string's power supply wires are wrongly connected.</li> </ol>	Add power supply quantity
Brightness of LED is not consistent or is not enough	<ol style="list-style-type: none"> <li>Power supply overloading.</li> <li>Too much current loss of power supply wires.</li> <li>More than one LED module string is seriesly connected.</li> </ol>	Connect each string directly to the master wires from power supply as the diagram above. Don't connect the string by series.
LED Twinkling	<ol style="list-style-type: none"> <li>Poor wire contacting</li> </ol>	Identify poor contacts and troubleshoot.
Individual LED don't work	Breakdown due to electrostatics.	Replace with new LED or new LED modules.